

ORDINANCE NO. 2546

AN ORDINANCE amending King County Zoning Resolution No. 25789, as amended, by amending the Zoning Map thereof reclassifying certain property thereon at the request of John N. Beerman, Division of Land Use Management File No. 248-74-R.

BE IT ORDAINED BY THE COUNCIL OF KING COUNTY:

SECTION 1. John N. Beerman petitioned on May 29, 1974, that the property described in Section 3 below be reclassified from G to S-R and this application was assigned Division of Land Use Management File No. 248-74-R.

SECTION 2. The report and recommendation of the Division of Land Use Management was transmitted to the Zoning and Subdivision Examiner on July 16, 1974, and July 15, 1975, and hearing was held by the Examiner on the matter July 23, 1974 and July 22, 1975. The report of the Examiner was filed with the Clerk of the King County Council on August 13, 1975, and the Council approved the reclassification by Motion No. 2109 on August 18, 1975.

SECTION 3. The legal description of the property to be reclassified is attached as Appendix A and is hereby made a part of this ordinance. The above described property is shown on the attached map which is designated Appendix B and is hereby made a part of this ordinance.

SECTION 4. The King County Council does hereby amend King County Zoning Code, Resolution No. 25789, as amended, by reclassifying that property described and shown in Section 3, Appendices A and B above, to S-R and

1 directs that Area Map E13-21-5 be modified to so designate.

2 INTRODUCED AND READ for the first time this 17<sup>d</sup> day  
3 of June, 1974.

4 PASSED at a regular meeting of the King County Council  
5 this 1<sup>st</sup> day of December, 1975.

6 KING COUNTY COUNCIL  
7 KING COUNTY, WASHINGTON

8 Bill Ream  
9 Chairman

10 ATTEST:

11  
12 Lorothy M. Quinn  
13 Clerk of the Council

DEEMED ENACTED WITHOUT  
COUNTY EXECUTIVE'S SIGNATURE.

14 APPROVED this \_\_\_\_\_ day of Dec. 11, 1975.

15  
16 \_\_\_\_\_  
17 KING COUNTY EXECUTIVE

FILE NO. 248-74-R  
APPENDIX A

**OVERALL LEGAL DESCRIPTION:**

The north 360' of the west  $\frac{1}{2}$  of the west  $\frac{1}{2}$  of the east  $\frac{1}{2}$  of the southeast  $\frac{1}{4}$  of the southeast  $\frac{1}{4}$  of Section 13, Township 21 North, Range 5 East, W.M., in King County, Washington, except county road.

Applicant: JOHN N. BEERMAN

FILE 248-74-R

Request: G to S-R

APPENDIX B

2516

STR: E 13-21-5



Proposed Reclassification

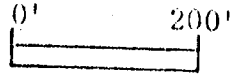

G

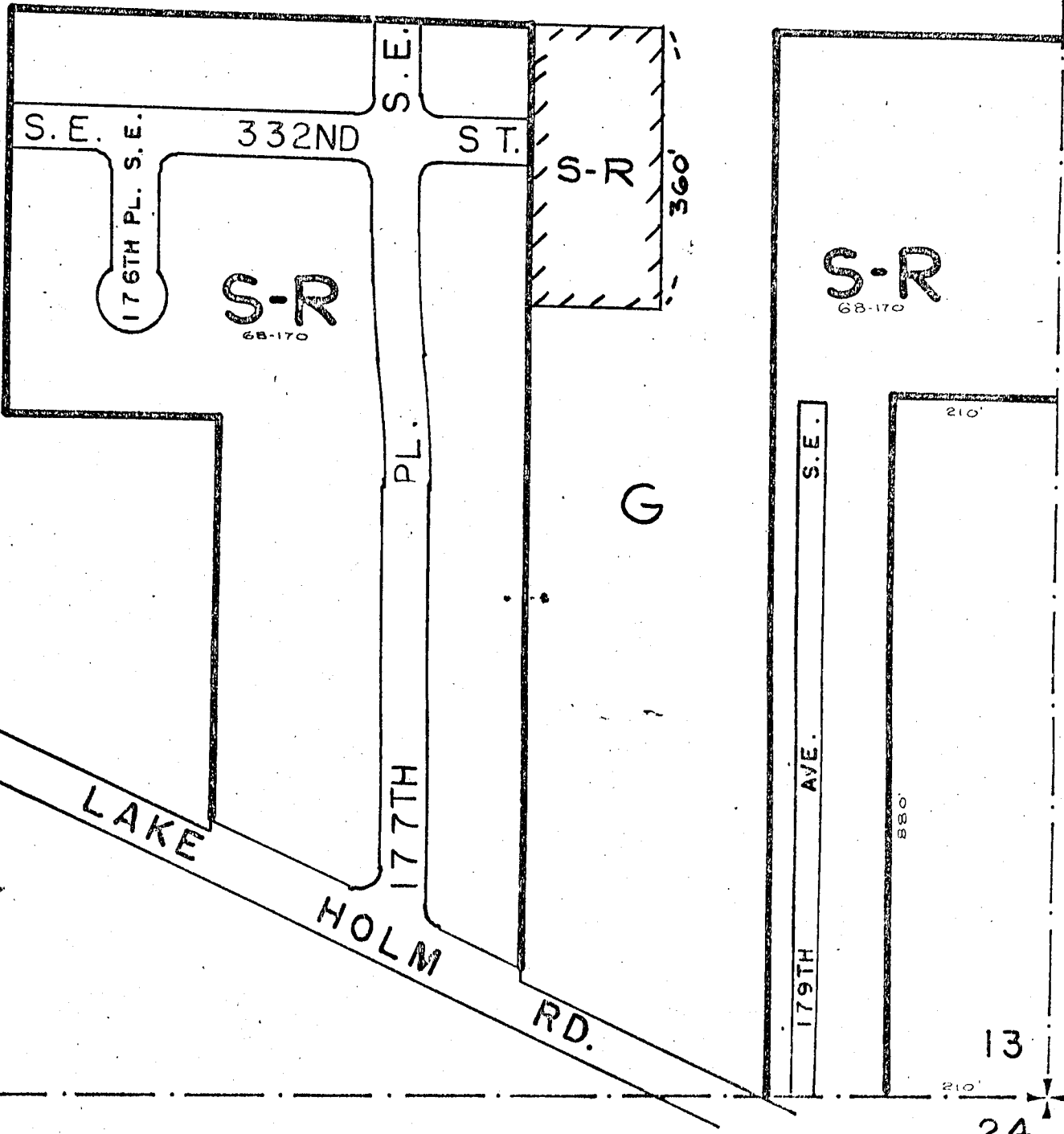

13 18  
24 19